

Plat of Survey

of

The West line of Lot 21 of Lackey Brothers Subdivision, Village of Williams Bay, Walworth County, Wisconsin.

Surveyed for: Al Johnson
83 Lackey Drive
Williams Bay, Wisconsin. 53191

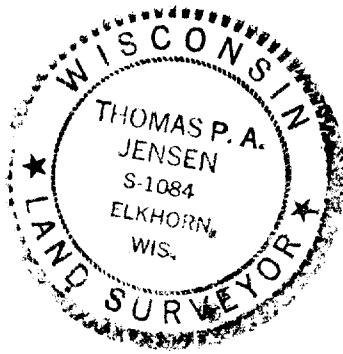
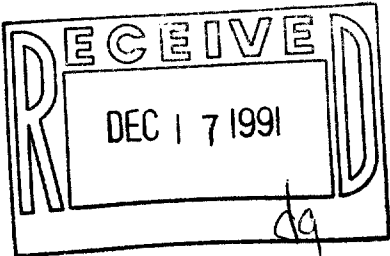
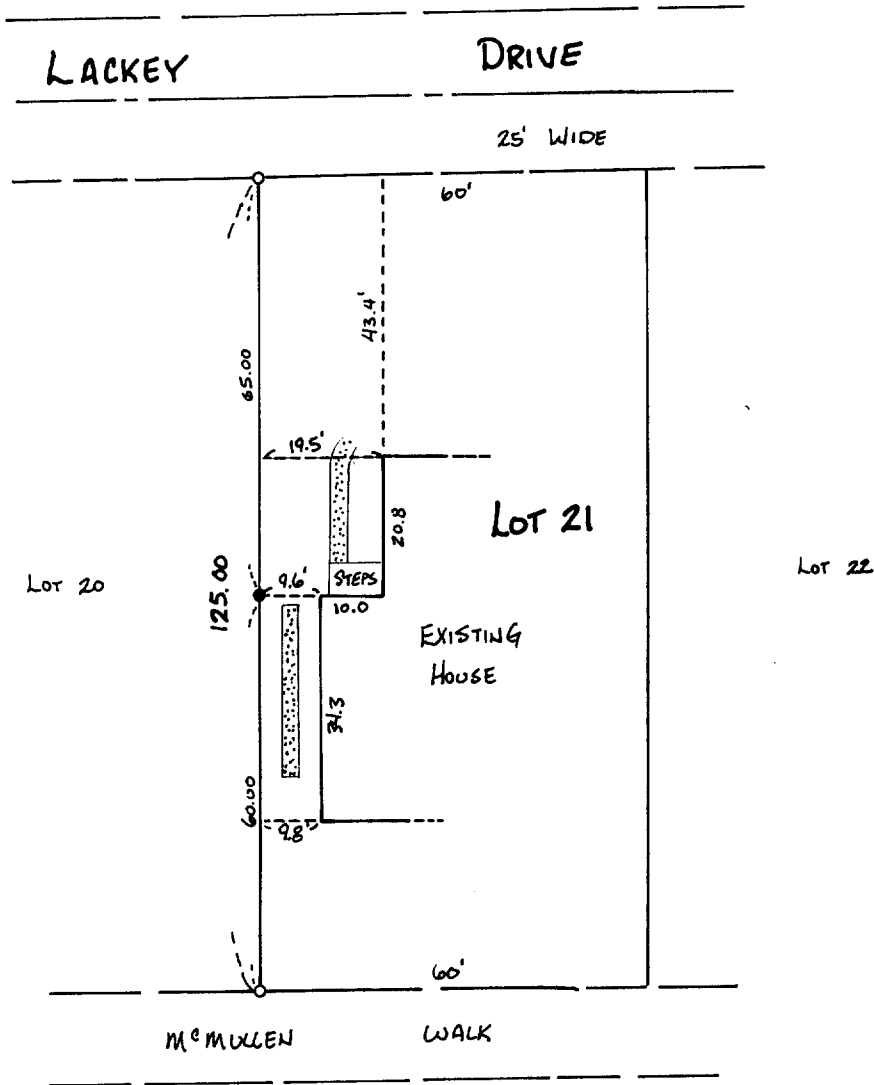

Copyright © 1990 by Jensen Surveying & Mapping S.C.
All rights reserved. No part of this survey plat may be reproduced or transmitted in any form by any means - graphic, electronic, or mechanical, including photocopying, tracing, or information storage and retrieval systems - without permission in writing from Thomas P.A. Jensen.

I, Thomas P.A. Jensen, Wisconsin Registered Land Surveyor, do hereby certify that this survey was performed by me, or under my direction, in full compliance with the owner's/agent's instructions and Chapter A-E 7 of the Wisconsin Administrative Code 'Minimum Standards For Property Surveys', and that this map is an accurate representation thereof to the best of my knowledge and belief.

Note: This survey plat is not certified unless signed and sealed in red ink.

Thomas P.A. Jensen
Thomas P.A. Jensen R.L.S. 1084

Legend

- o ~ Found iron pipe
- ~ Set iron rod 3/4 dia.
- ▨ ~ Concrete surface (SIDEWALK)

Jensen Surveying & Mapping S.C.
45 South Wisconsin Street P.O. Box 322
Elkhorn, Wisconsin. 53121.
(414) 723-3434

Mapping date: October 2, 1990

Revisions: _____

Sheet 1 of 1 Sheets

Job reference number:

1990.152 X

Scale: 1 = 30'



011-867

WLB-21